

### Tipo di telo

40 mm

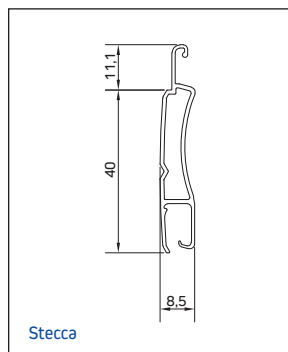

Con microperforazione

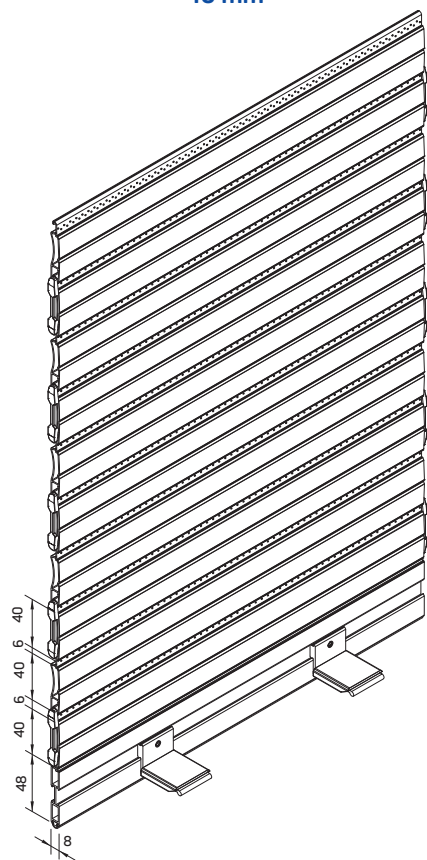
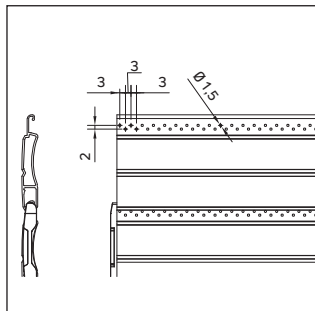

Senza microperforazione

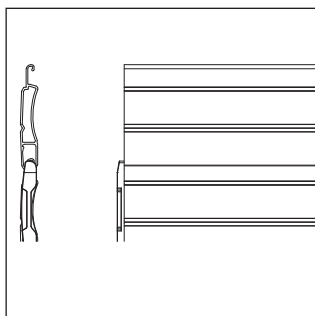

Con insonorizzazione tra le stecche

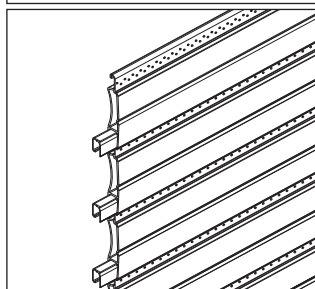

Barra Finale

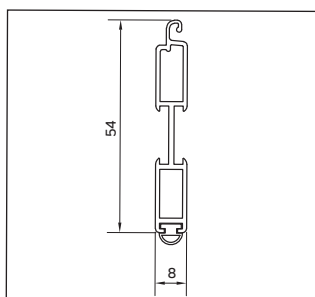

25 mm

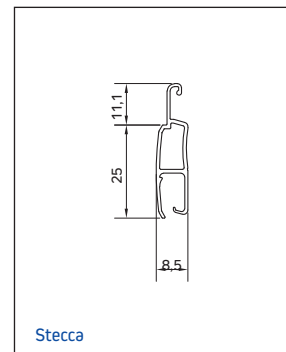
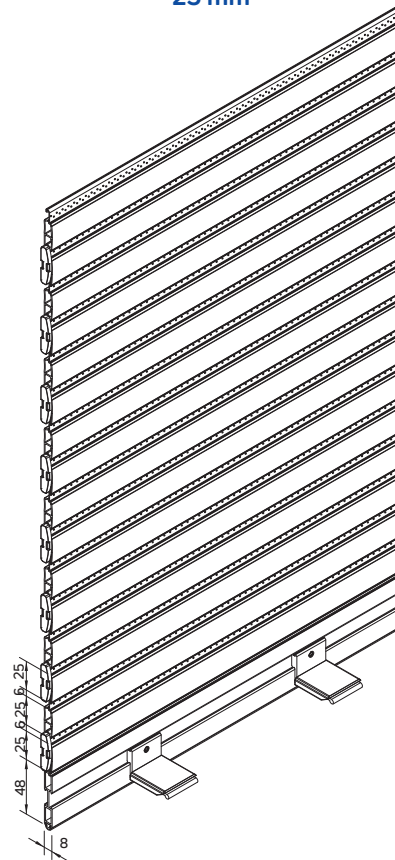

**Sezione verticale**  
Azionamento a manovella

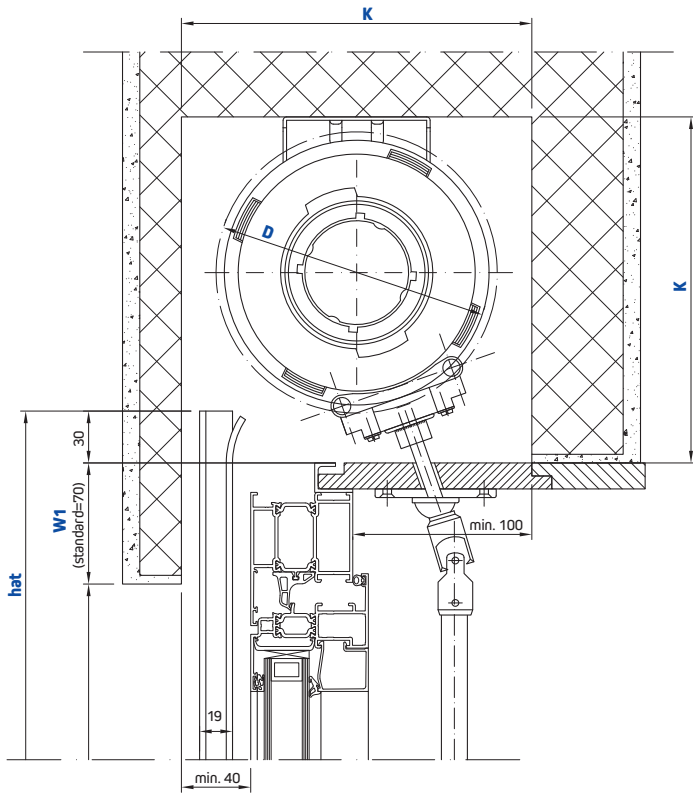

**Sezione verticale**  
Azionamento a motore

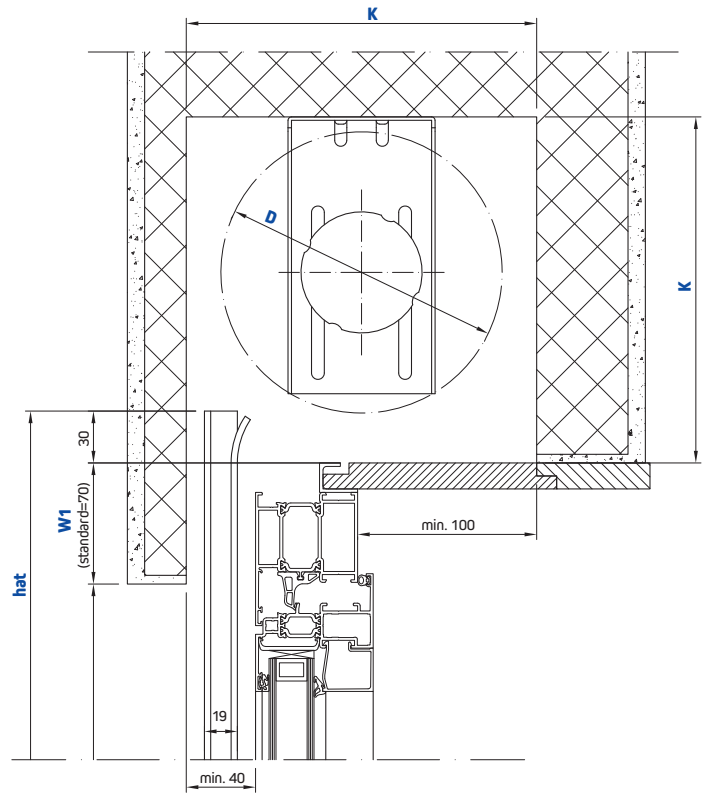

**Tipologie di guide**

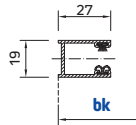

Guida standard	<b>NO</b>
----------------	-----------

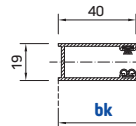

Guida rinforzata	<b>BR</b>
bk ≥ 2'500 mm	

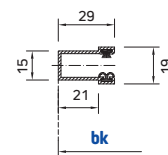

Guida a incasso	<b>EF</b>
-----------------	-----------

**Risparmio minimo**  
senza comando

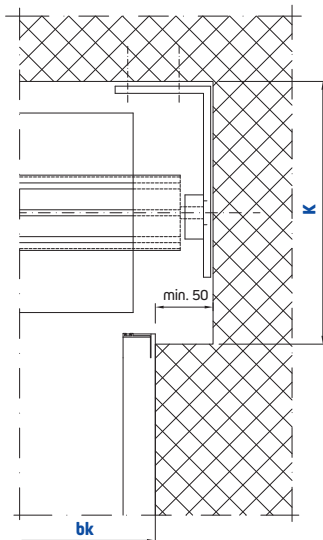

**Risparmio minimo con**  
comando a motore

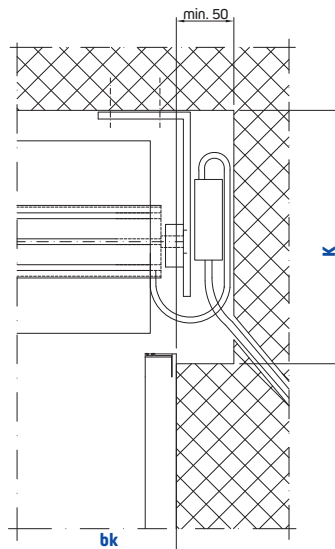

**Risparmio minimo con**  
comando a manovella

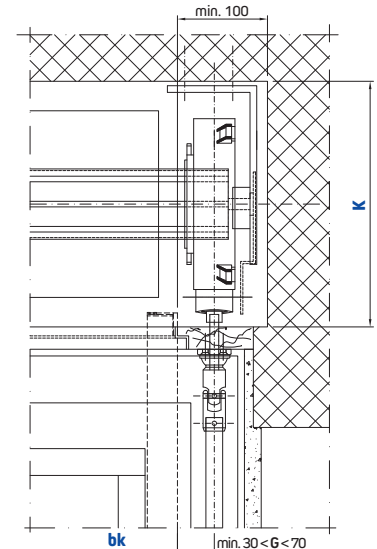

Supporto intermedio tra due rulli

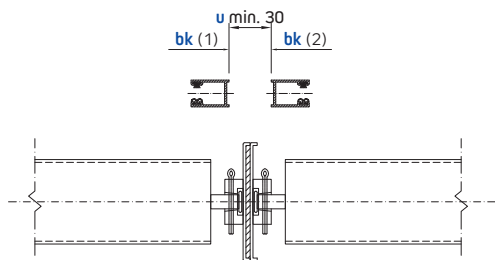

Due rulli con un solo comando

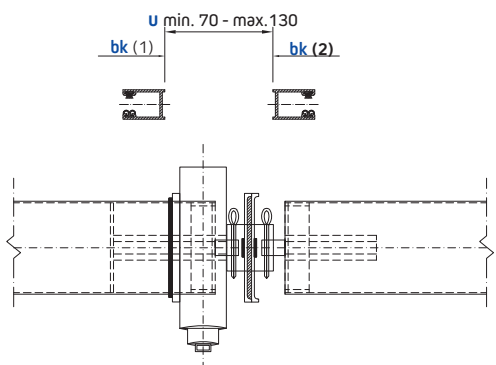

Due rulli con due comandi

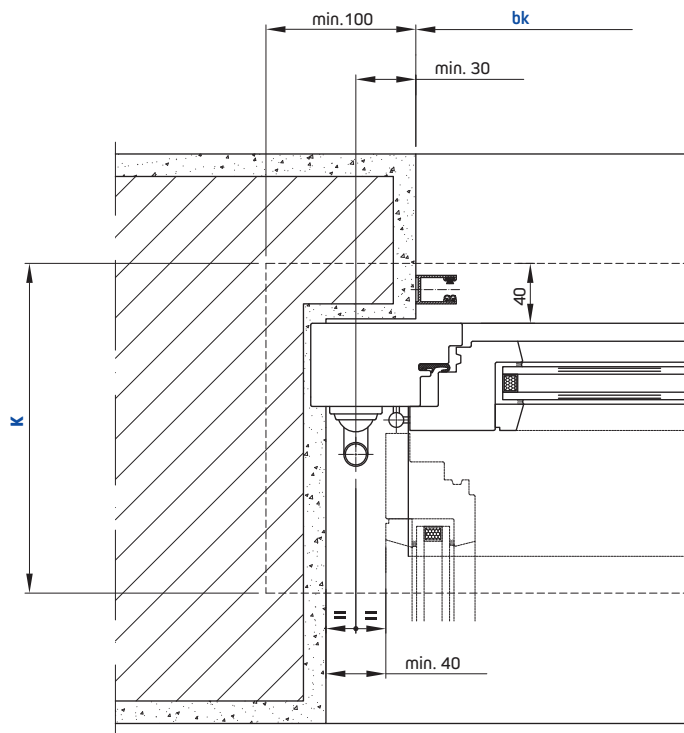
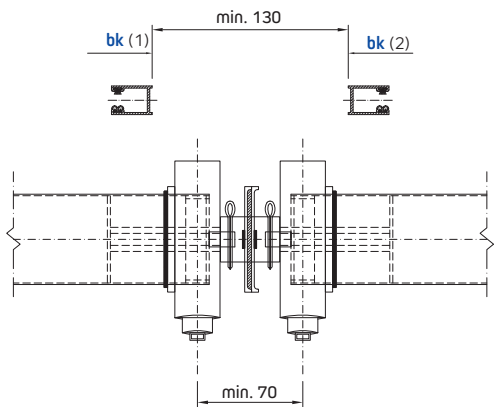

Comando a manovella  
con serramento in metallo

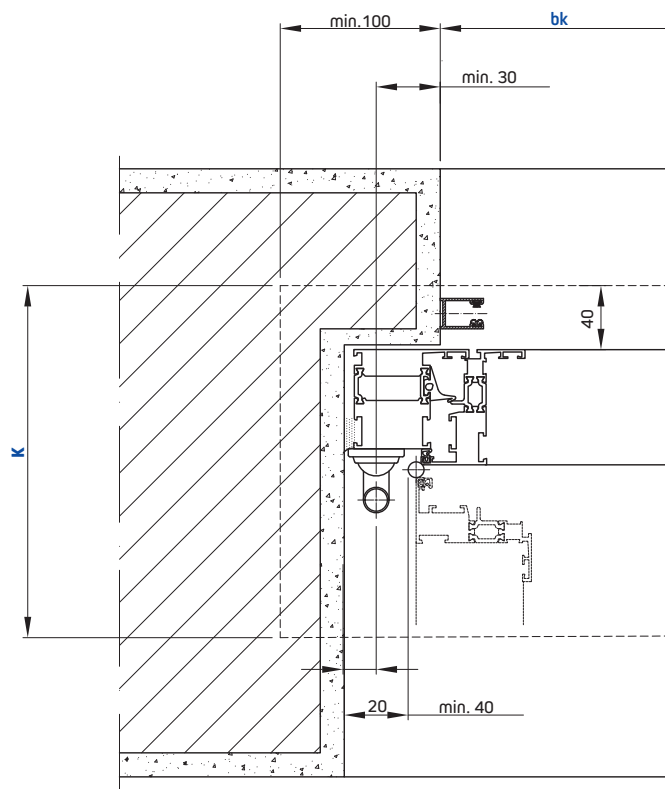

## Dati tecnici

### Regasicur® 40 mm      Regasicur® 25 mm

Altezza massima della luce (hl)	3'000 mm	3'000 mm
Larghezza luce (bk)		
• Minima con arganello	300 mm	300 mm
• Minima con motore	600 mm	600 mm
• Massima	3'000 mm	3'000 mm
Superficie massima (bk x hl)		
• con arganello e molla d'aiuto	7 m <sup>2</sup>	6 m <sup>2</sup>
• con motore	9 m <sup>2</sup>	9 m <sup>2</sup>
• con motore - teli accoppiati	12 m <sup>2</sup>	11 m <sup>2</sup>

Peso per m <sup>2</sup>	3,5 kg ca.	3,7 kg ca.
-------------------------	------------	------------

## Legenda

bk	Larghezza luce
hl	Altezza luce
D	Diámetro del telo avvolto
K	Dimensione minima del cassonetto
g	Misura dalla schiena guida alla mezzeria snodo manovella
u	Distanza di accoppiamento
hat	Lunghezza totale della guida
w1	Prolungamento della guida

## Dimensioni minime del cassonetto (K) con supporto standard

Regasicur® 40 mm

70	• hl	800	900	1'000	1'100	1'300	1'400	1'1500	1'600	1'700
	• K	180	180	185	185	195	195	195	200	205
70	• hl	1'800	1'900	2'000	2'200	2'400	2'500	2'800	3'000	
	• K	210	210	210	220	230	235	240	245	

Regasicur® 25 mm

70	• hl	800	900	1'000	1'100	1'300	1'400	1'1500	1'600	1'700
	• K	180	185	190	195	210	210	215	215	215
70	• hl	1'800	1'900	2'000	2'200	2'400	2'500	2'800	3'000	
	• K	215	215	220	225	230	230	240	240	

## Resistenza contro le forze del vento\*

Larghezza bk	1'000	1'500	2'000	2'500	3'000
Classe	6	5	5	3	3

## Resistenza contro le forze del vento secondo le direttive tecniche VSR (Associazione dei fornitori svizzeri di protezione solare e contro le intemperie)

Classe	0	1	2	3	4	5	6
Vento	<9.0 m/s	<9.0 m/s	11 m/s	13 m/s	17 m/s	21 m/s	26 m/s
Vento	32 km/h	32 km/h	39 km/h	46 km/h	60 km/h	76 km/h	92 km/h